

GENERAL APPLICABILITY

UNIVERSAL

KIT CONTENTS

ITEM	QTY	DESCRIPTION
1	2	LED DAYTIME RUNNING LIGHTS*
2	1	CONTROL MODULE
3	1	DRL EXTENSION HARNESS (LONG)
4	2	FUSE HARNESS
5	1	GROUND HARNESS
6	1	HARDWARE
7	2	BEZELS (LEFT AND RIGHT)

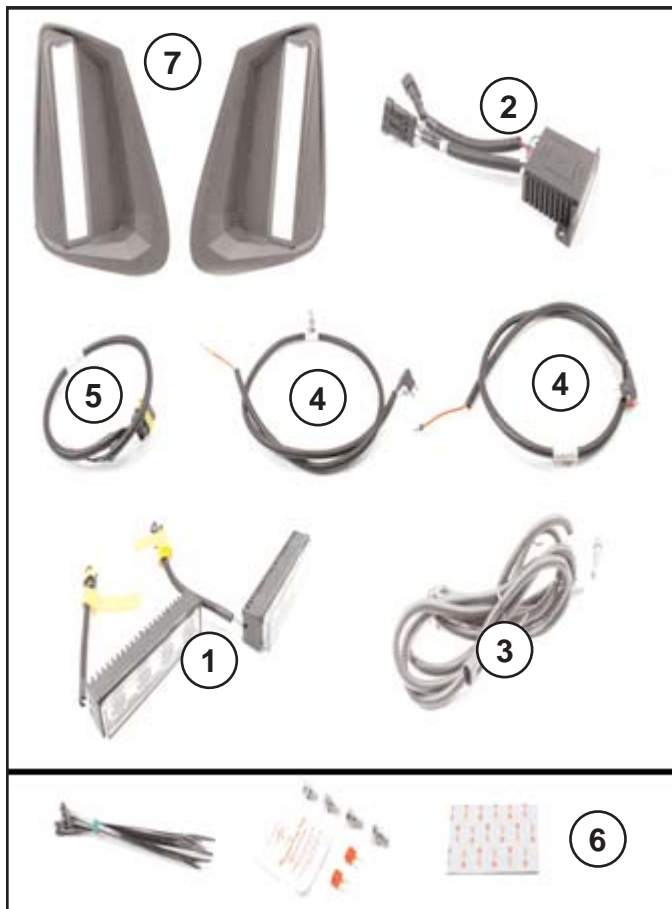

UNIVERSAL HARDWARE KIT CONTENTS

ITEM	QTY	DESCRIPTION
1	10	WIRE ZIP TIES
2	4	BOLTS W/ WASHERS, LOCKWASHER
3	1	ALCOHOL PAD
4	1	VHB TAPE
5	2	10 AMP FUSE

RECOMMENDED TOOLS

PERSONAL & VEHICLE PROTECTION	
SAFETY GLASSES	
MASKING TAPE	
SPECIAL TOOLS	
VOLT-OHM METER	
RECOMMENDED INSTALLATION TOOLS	
TRIM REMOVAL TOOL	PHILLIPS SCREWDRIVER
TAPE MEASURE	10-MM WRENCH
DRILL BITS	SOLDERING TOOL
WIRE CUTTERS	SHARP KNIFE
SPECIAL CHEMICALS	

CONFLICTS

NOTE:

LEGEND

	STOP: DAMAGE TO VEHICLE MAY OCCUR. DO NOT PROCEED UNTIL PROCESS COMPLIANCE HAS BEEN MET.
	OPERATOR SAFETY: USE CAUTION TO AVOID RISK OF INJURY.
	CRITICAL PROCESS: PROCEED WITH CAUTION TO ENSURE A QUALITY INSTALLATION. THESE POINTS WILL BE AUDITED ON A COMPLETED VEHICLE INSTALLATION.
	GENERAL PROCESS: THIS HIGHLIGHTS SPECIFIC PROCESSES TO ENSURE A QUALITY INSTALLATION. THESE POINTS WILL BE AUDITED DURING THE ACCESSORY INSTALLATION.
	TOOLS & EQUIPMENT: THIS CALLS OUT THE SPECIFIC TOOLS AND EQUIPMENT REQUIRED FOR THE PROCESS.
	REVISION MARK: THIS MARK HIGHLIGHTS A CHANGE IN INSTALLATION WITH RESPECT TO PREVIOUS ISSUE.



IMPORTANT

NOTE!

- ❑ **INSTALLATION MUST BE DONE IN STRICT ACCORDANCE WITH THE INSTALLATION INSTRUCTIONS.**
- ❑ **DAYTIME RUNNING LIGHTS (DRLs) ARE DESIGNED TO TURN ON WITH IGNITION AND REMAIN ON UNTIL IGNITION IS TURNED OFF. DRLs ARE NOT A SUBSTITUTE FOR HEADLIGHTS AT DUSK/DAWN OR DURING DARKNESS.**
- ❑ THE DRLs COME PROGRAMMED TO BE USED AS POSITION LIGHTS (DIMMING THE DRLs WHEN THE HEADLIGHT SWITCH IS ON). TO TURN THE POSITION FEATURE OFF, CONNECT THE DRLs AS DESCRIBED IN THE INSTRUCTIONS BELOW, THEN:
 - TURN ACC/IGNITION ON.
 - QUICKLY TURN THE HEADLIGHT SWITCH ON AND OFF THREE TIMES AND THE FOURTH TIME LEAVE THEM ON.
NOTE: THE DRLs WILL FLASH MOMENTARILY.
 - QUICKLY TURN THE HEADLIGHT SWITCH ON AND OFF TWO TIMES AND THE THIRD TIME LEAVE THEM ON. THIS WILL TURN THE POSITION LIGHT FEATURE OFF.
 - TO TURN THE POSITION LIGHT FEATURE ON, REPEAT THE STEPS ABOVE.
- ❑ PLEASE ENSURE ALL WIRING IS LAID SO THAT IT CANNOT BE PULLED OR ABRADED AND IS SECURELY FASTENED WITH WIRE TIES.

ATTENTION: FOGGING OF THE LENSES

MODERN HEADLAMPS ARE VENTILATED TO AVOID CORROSION. THIS MEANS THAT IN CERTAIN CONDITIONS CONDENSATION COLLECTS INSIDE OF THE LENS. THIS SHOULD DISAPPEAR SHORTLY AFTER THE DRL IS TURNED ON.

FOGGING OF THE LENS IS NO REASON FOR COMPLAINT!

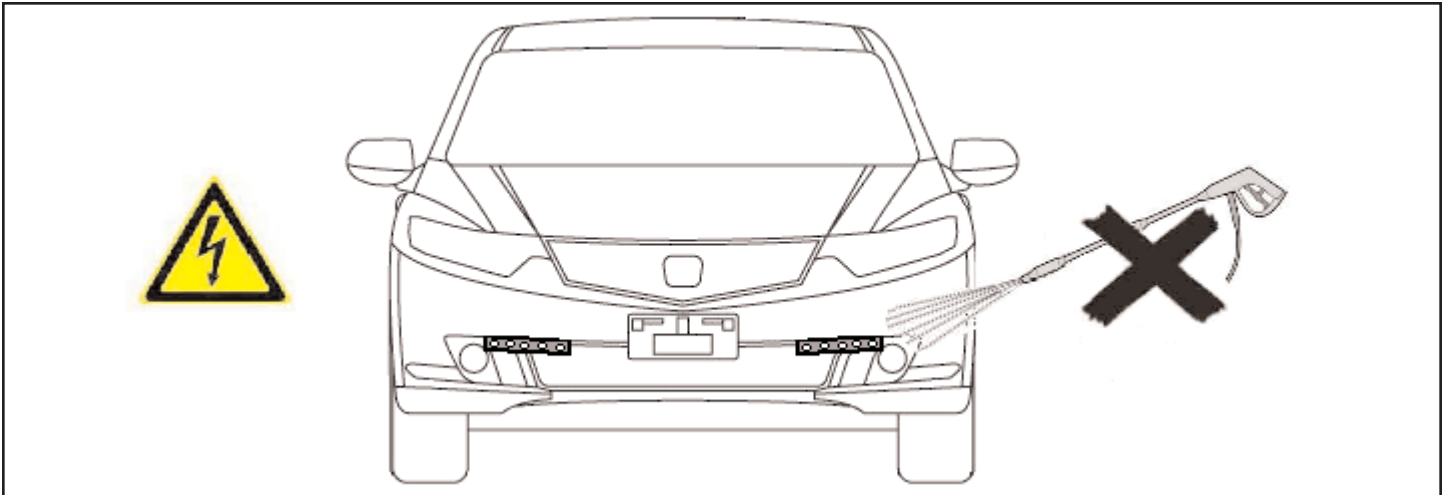

INSTALLATION

STEP 1: DRL MOUNTING INSTRUCTIONS

1. IT IS ADVISABLE TO DISCONNECT THE NEGATIVE BATTERY CABLE FOR 3 MINUTES BEFORE BEGINNING INSTALLATION TO AVOID UNINTENDED AIR BAG DEPLOYMENT.

NOTE: RECORD ANY ANTI-THEFT RADIO CODES PRIOR TO DISCONNECTING.

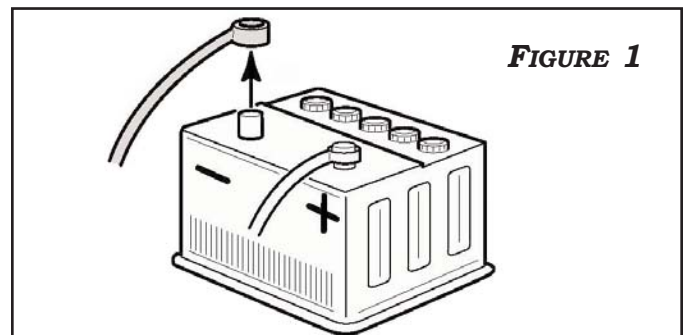

INSTALLATION

STEP 1: DRL MOUNTING INSTRUCTIONS (CONT'D)

2. MAKE SURE THE INSTALLATION POSITION OF THE ROSTRA DRLS CONFORMS TO THE DIAGRAMS IN **FIGURES 2 & 3**.

INSTALLATION REQUIREMENTS:

- REMOVE EXISTING BEZEL FROM VEHICLE AND INSTALL NEW DRLS. **FIGURE 2**
- LIGHT MUST BE VISIBLE FROM 20° INBOARD AND OUTBOARD, AS WELL AS FROM 10° ABOVE AND BELOW THE HORIZONTAL AXIS.
- TWO LIGHTS ARE REQUIRED FOR MOTOR VEHICLES.
- THE DRL MUST DIM WHEN THE HEADLIGHTS ARE ON. **FIGURE 3**



STEP 2: ELECTRICAL INSTALLATION (REFER TO FIGURE 4)

1. CONNECT THE GREY/WHITE CONNECTOR OF THE DRL EXTENSION HARNESS TO THE PASSENGER'S SIDE DRL.
2. CONNECT THE BLACK/WHITE CONNECTOR OF THE DRL EXTENSION HARNESS TO THE DRIVER'S SIDE DRL.
3. CONNECT THE 4 PIN CONNECTOR OF DRL EXTENSION HARNESS TO THE CONTROL MODULE.
4. **+12V ACCESSORY POWER CONNECTION:** REMOVE +12V ACCESSORY FUSE FROM AN IGNITION SWITCHED ACCESSORY IN THE ACCESSORY FUSE BOX AND REPLACE IT WITH THE FUSE ADAPTOR OF ONE OF THE RED IGNITION WIRES. INSERT THE FUSE INTO OPEN SLOT (LOWER) OF FUSE ADAPTOR. **SEE FIGURE 5 & 6** INSERT THE PIN (TERMINAL) INTO POSITION 2 OF 3-PIN CONNECTOR AS SHOWN IN **FIGURE 4**.
5. **ILLUMINATION CONNECTION:** REMOVE FUSE FROM HEADLIGHT OR HEADLIGHT SWITCH POSITION IN THE ACCESSORY FUSE BOX AND REPLACE IT WITH THE FUSE ADAPTOR OF THE OTHER RED IGNITION WIRE. INSERT THE FUSE INTO OPEN SLOT (LOWER) OF FUSE ADAPTOR. **SEE FIGURE 5 & 6** INSERT THE PIN (TERMINAL) INTO POSITION 3 OF 3-PIN CONNECTOR AS SHOWN IN **FIGURE 4**.

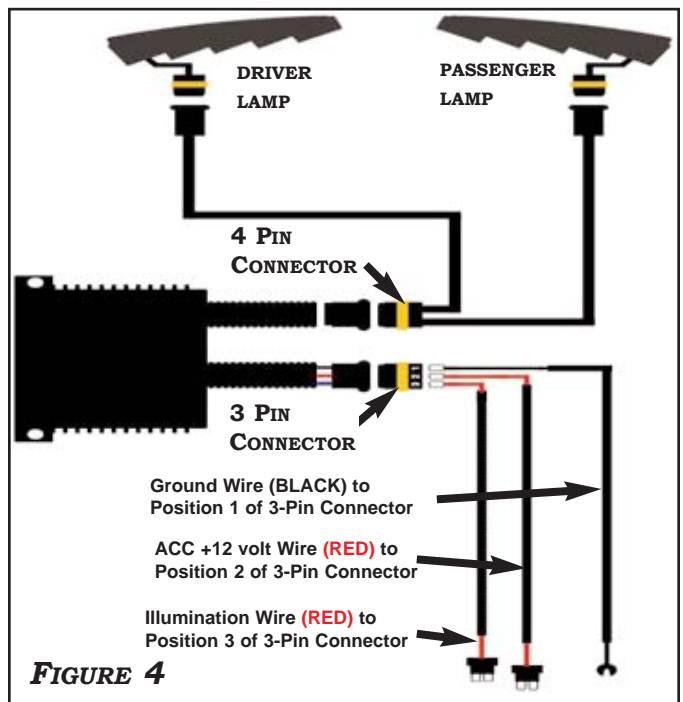

INSTALLATION

STEP 2: ELECTRICAL INSTALLATION

(CONTINUED)

6. GROUND CONNECTION: CONNECT RING TERMINAL OF BLACK GROUND HARNESS TO VEHICLE GROUND POINT OR NEGATIVE (-) BATTERY TERMINAL. **FIGURE 7** INSERT THE PIN (TERMINAL) INTO POSITION 1 OF 3-PIN CONNECTOR AS SHOWN IN **FIGURE 4**.

7. SECURE THE CONTROL MODULE ON THE DRIVER'S SIDE FENDER WELL USING THE PROVIDED DOUBLE-SIDED TAPE AND/OR HARDWARE.

NOTE: THOROUGHLY CLEAN THE AREA WITH THE PROVIDED ISOPROPYL ALCOHOL PAD OR OTHER ACCEPTABLE CLEANER. **FIGURE 8**

STEP 3: TEST ALL FUNCTIONS

NOTE: MAKE SURE THE DRLS ARE CONNECTED TO THE CONTROL MODULE PRIOR TO RECONNECTING THE BATTERY.

1. RECONNECT THE BATTERY.
2. ENSURE DRLS REMAIN ON WHILE THE ACC POWER IS ON.
3. ENSURE DRLS DIM WHEN HEADLIGHTS ARE TURNED ON.

STEP 4: REASSEMBLY

1. REASSEMBLE THE VEHICLE.
2. SECURE ALL WIRES WITH ZIP TIES AWAY FROM THE ENGINE AND ANY SHARP/MOVING OBJECTS.

